

# Savannah 7236SD | Air A18 Massage Series

Product Number: SAA18J7236SDFS-A 72" x 36" x 25"



## STANDARD & OPTIONAL ACCESSORIES

### JETS: 18 Total

- X 18 EZ Clean HTT Air Jets

### PUMPS

1.25 Air Power Variable Speed, Pulse & Wave Heated Air Pump  
Quiet Pad Anti-Vibration Mounted Pumps

### HEATERS

Heated Air Pump  
Warm Back Rest Tubing Zone

### CONTROLS

Air Switch On/Off Control(s) for Underwater Light  
Variable Speed Air Massage Control Automatic Purge  
& Dry Cycle Control

### PURITY

HydroCleanse

### DRAINS & OVERFLOWS INFORMATION

- Overflow: Integral Round or Linear: Included Polished Chrome  
Optional: White, Biscuit, Black, Brushed Nickel, Polished Nickel, Oil Rubbed Bronze
- Bath Drain: Pop up: Included Polished Chrome  
Optional: White, Biscuit, Black, Brushed Nickel, Polished Nickel, Oil Rubbed Bronze
- In Floor Drain EZ Fast Connect (optional)

### FAUCET INFORMATION

- Deck Mount or Floor mount (not included)
- Access Panel required for Deck faucet (optional)
- Floor mount verify spout distance

### STANDARD ACCESSORIES

Underwater Lighting • Deluxe Cushion Pillow • EZ Level Base  
• FDA Recipe Non-Toxic Food & Beverage Grade Plumbing (primarily) • 30 Point Quality Assurance Factory Test



### TECHNICAL SPECIFICATIONS

Side drain  
Pump Location(s): #1 LF or #4 RF  
– right or left side access

### ELECTRICAL REQUIREMENTS

(1) 115v 20AMP GFCI Circuits



Equipment Access Panel

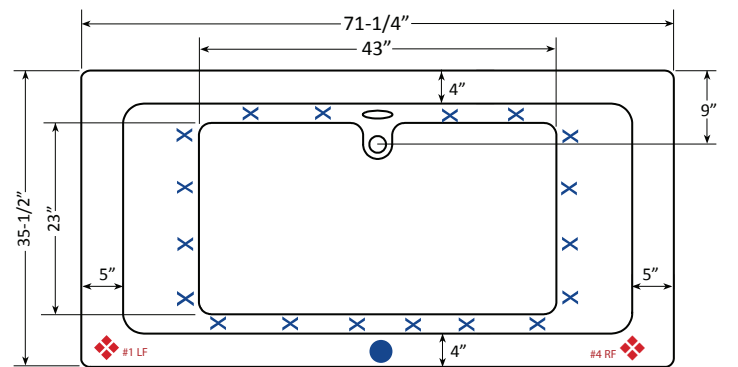

Faucet Access Panel

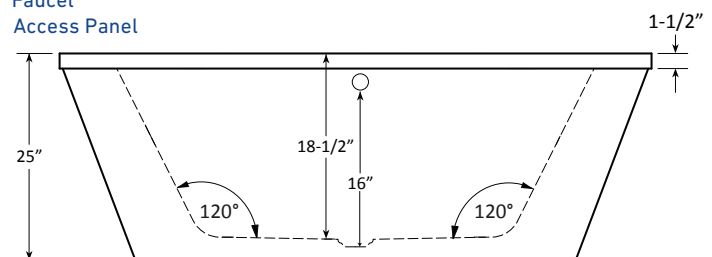

Specifications and features are subject to change without notice and are + .25". All final measurements should be taken from tub on site.

HydroMassage Products LLC • 303-341-1845 • Fax: 303-342-1850 • www.hydromassageproducts.com